



6/90 The Crescent Homebush West NSW

Located above Flemington's main grocery shopping and dining district

Excellent exposure for local inner west residents

Ideal for tutoring schools, business offices, and professional services

Flexible lease terms available

Conveniently situated next to a public car park and a minute's walk from Flemington station.

Price : \$71,000 pa

Building Size : 62 sqm

View : <https://www.srmetro.com.au/lease/nsw/inner-west/homebush-west/commercial/retail/7962961>



Stephen Shen
02 9283 2832

SCHEDULE OF UNIT ENTITLEMENT	
LOT N°	ENTITLEMENT
1	48
2	48
3	48
4	48
5	54
6	50
7	40
8	46
9	76
10	76
11	76
12	710
AGGREGATE	1000

NOTE: • ALL AREAS ARE APPROXIMATE.
 • C.P. DENOTES COMMON PROPERTY

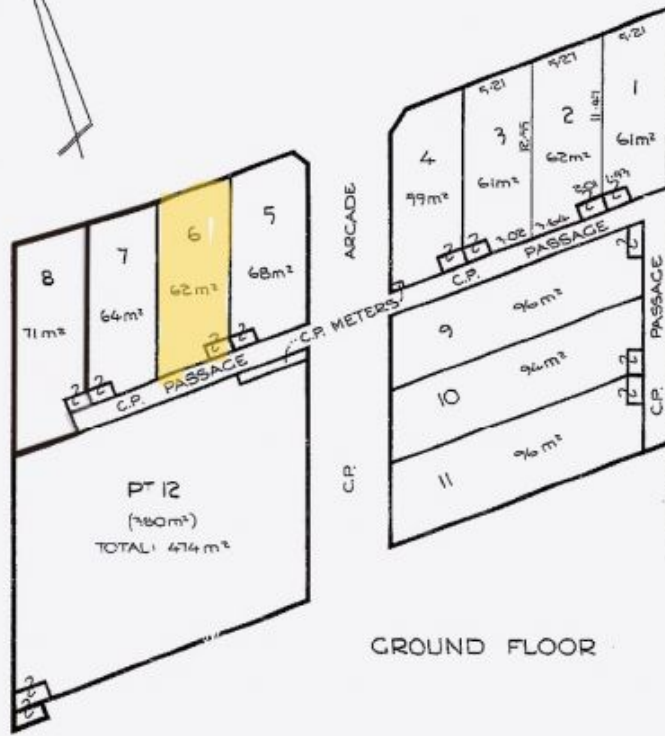
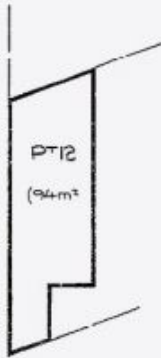

MEZZANINE FLOOR

GROUND FLOOR

Reduction Ratio 1:250

Lengths are in metres

J. J. [Signature]
 Registered Surveyor

[Signature]
 Council Clerk

SURVEYOR'S REFERENCE: 51761