



Visualisation



Visualisation



## 2/60 Park Street Sydney NSW

Located on prime Park Street in the heart of Sydney CBD with moments to Town Hall, QVB and Hyde Park, and close to the financial centre, cultural attractions, great dining and entertainment, this ground floor retail shop offers a wonderfully convenient and affordable long term opportunity for any astute business operator.

### Property Features:

Full glass wall shop front

Total size 55 sqm (41sqm internal area, 14 sqm with toilet & storage cage)

Air Conditioning

Welcoming all types of business probability including general and special retail, sushi/sandwiches take away, boutique brunch/coffee shops, consulting offices, dentist, barber and beauty salon, tobacco, and fashion.

To enquiry and arrange private viewing, please contact

**Price** : \$90, 000 pa  
**Building Size** : 55 sqm  
**Land Size** : 55 sqm  
**View** : <https://www.srmetro.com.au/lease/nsw/sydney-city/sydney/commercial/retail/6941531>



**Farrah Cartwright**  
**0420 311 618**

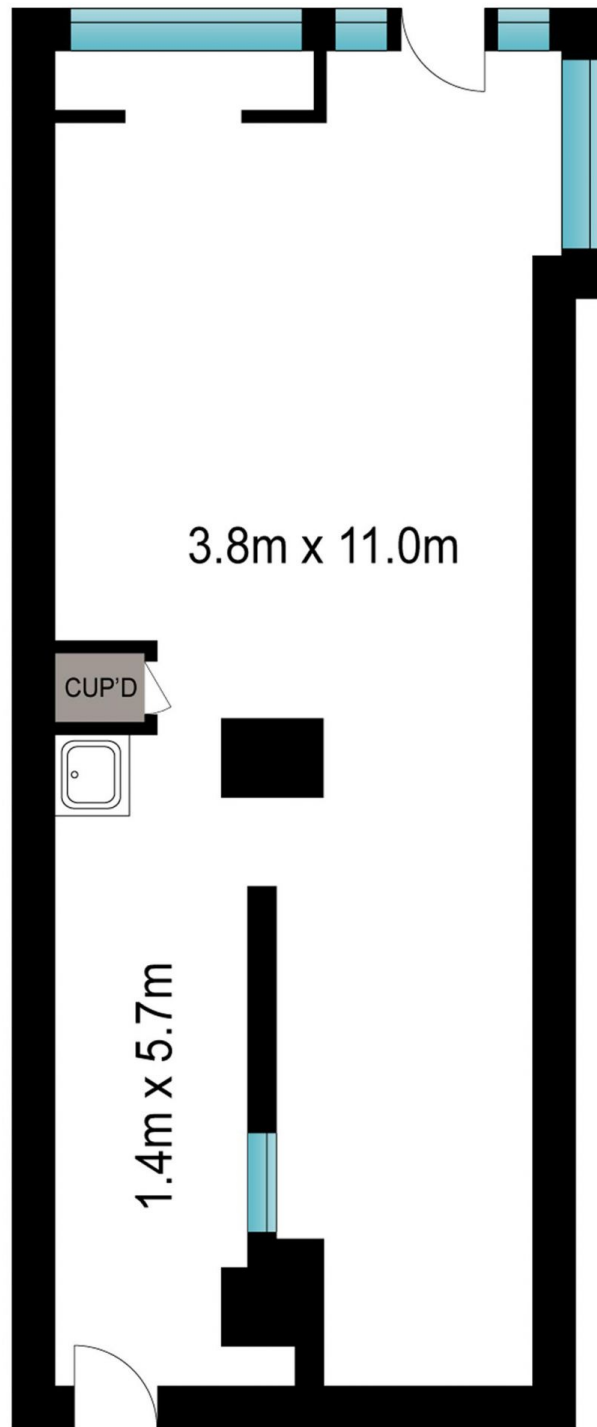

Scale in metres. Indicative only. Dimensions are approximate. All information contained herein is gathered from sources we believe to be reliable. However we cannot guarantee its accuracy and interested persons should rely on their own enquiries.

INT: 41 m<sup>2</sup>



60 Park Street, Sydney