



Level 17/27 Park Street Sydney NSW



Immersed in the iconic Park Regis with secured tenant, this cosy studio apartment presents a wonderfully convenient and affordable city address. An astute investment opportunity capturing view across Hyde Park, it's just moments to the financial centre, cultural attractions, great dining and entertainment.

View : <https://www.srmetro.com.au/sale/nsw/sydney-city/sydney/residential/apartment/5717598>

Prime CBD location on Park Street
Inviting 31sqm of living space
North east facing with Hyde Park view
Recently renovated kitchenette and bathroom
Communal roof top with pool and coin operated laundry facilities
Strong consistent rental returns



Paul Ding
02 9283 2832

Strata levies: \$574 qtr approx
Council rate: \$292 qtr approx.

<https://www.srmetro.com.au>

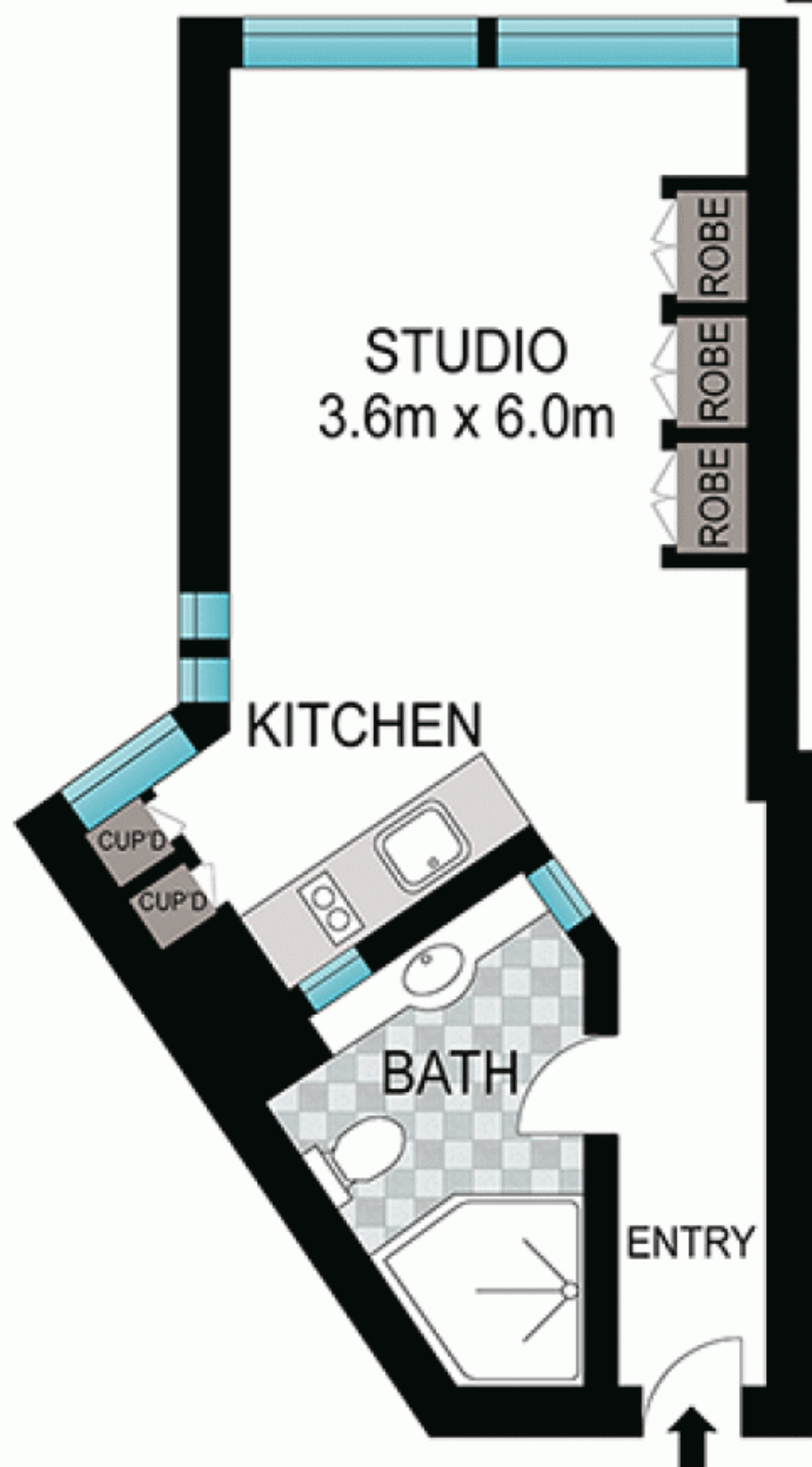

INT: 31 m²



Scale in metres. Indicative only. Dimensions are approximate. All information contained herein is gathered from sources we believe to be reliable. However we cannot guarantee its accuracy and interested persons should rely on their own enquiries.

174/27 Park Street, Sydney