



4/267 Castlereagh Street Sydney NSW

2 🏠 2 🚗 1 🚗

Offering a vibrant City life style with a secret sanctuary of private outdoor space is this rarely found unique courtyard apartment. Tastefully refined and presented, with its easterly light and leafy seclusion, and secure and easy entertaining, this chic apartment is a must have for any connoisseur of good taste.

Building Size : 130 sqm
Land Size : 148 sqm
View : <https://www.srmetro.com.au/sale/nsw/sydney-city/sydney/residential/apartment/5717590>

Desirable Hyde Park fringe location, walk to rail
 Partly renovated with scope for makeover
 130sqm of seamless indoor/outdoor living space
 2 bedrooms both aglow with refreshing morning sunlight
 Extra large security car space on title
 Common facilities include indoor pool, gym & squash court

Strata Levies: \$2,970 qtr approx
 Council Rate: \$354 qtr approx



Paul Ding
 02 9283 2832



Wilson Diec
 02 9283 2832

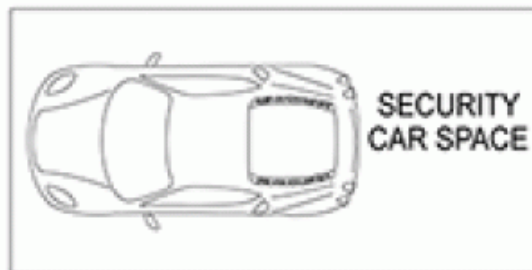
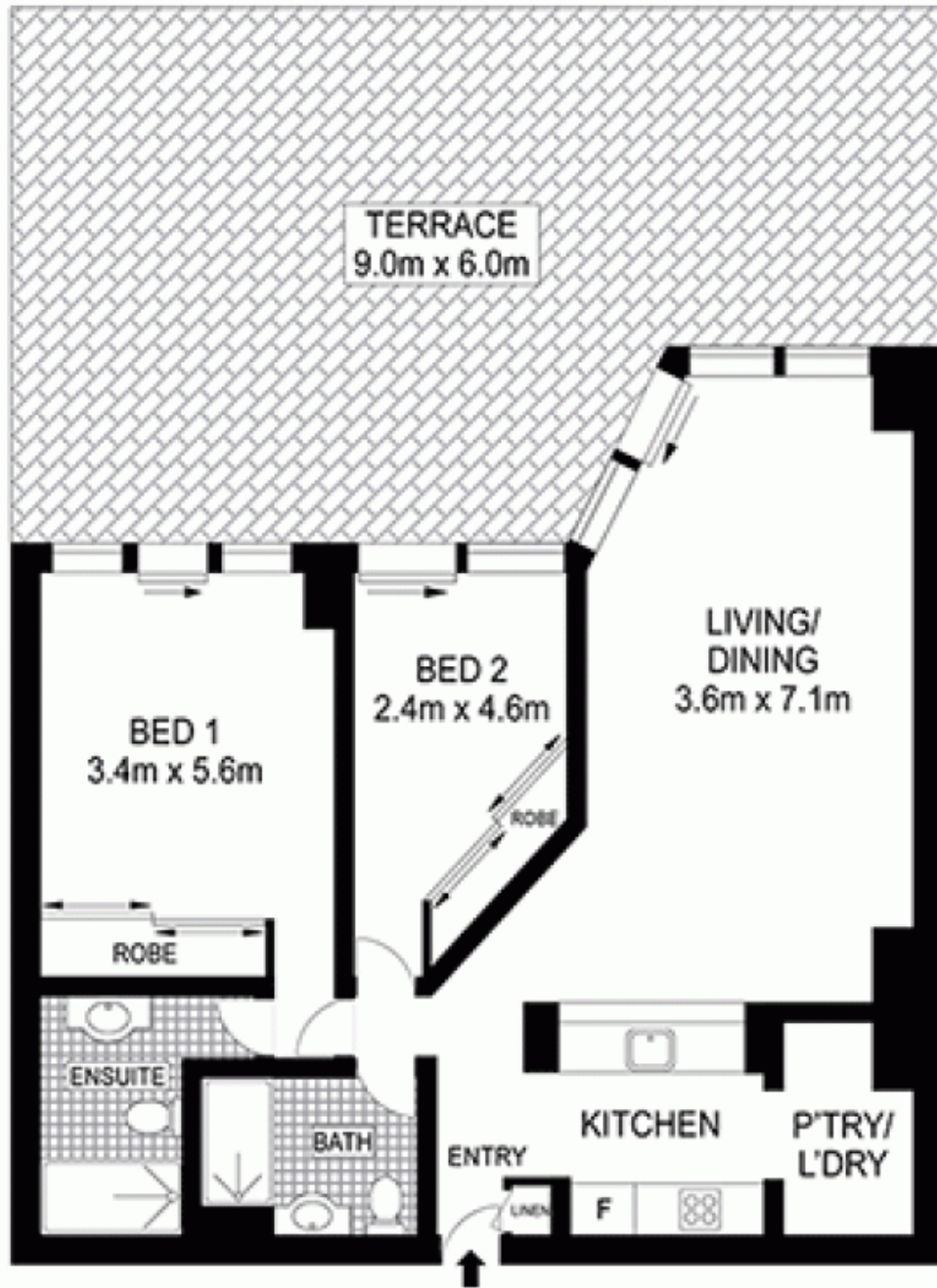

Scale in metres. Indicative only. Dimensions are approximate. All information contained herein is gathered from sources we believe to be reliable. However we cannot guarantee its accuracy and interested persons should rely on their own enquiries.

Approx. apartment: 130sq.m.
 Approx. car space: 18sq.m.
 Approx total: 148sq.m.



4/267 Castlereagh Street, Sydney