



1306/348-352 Sussex Street Sydney NSW

1 1 1

Advantageously positioned at the corner of Liverpool and Sussex St, this immaculately presented one bedroom apartment is set in the popular 'Landmark' building within moments to Town Hall and World Square Shopping.

Features approx 67sqm of living space this delightful apartment boasts a superb array of shops, cafes, bars and restaurants at its doorstep.

- Impressive living and dining open to light filled balcony
- Oversized granite kitchen with gas appliances
- Double bedroom with balcony access and built-ins
- Ducted air-conditioning, internal laundry
- Full brick construction; Security building with on-site manager
- Extra large 21sqm security carspace ideally located on B3
- Recreational facilities including gymnasium and heated

Price : \$ 802,000

View : <https://www.srmetro.com.au/sale/nsw/sydney-city/sydney/residential/apartment/5716939>



Bernard Tsang
02 9283 2832



Wilson Diec
02 9283 2832

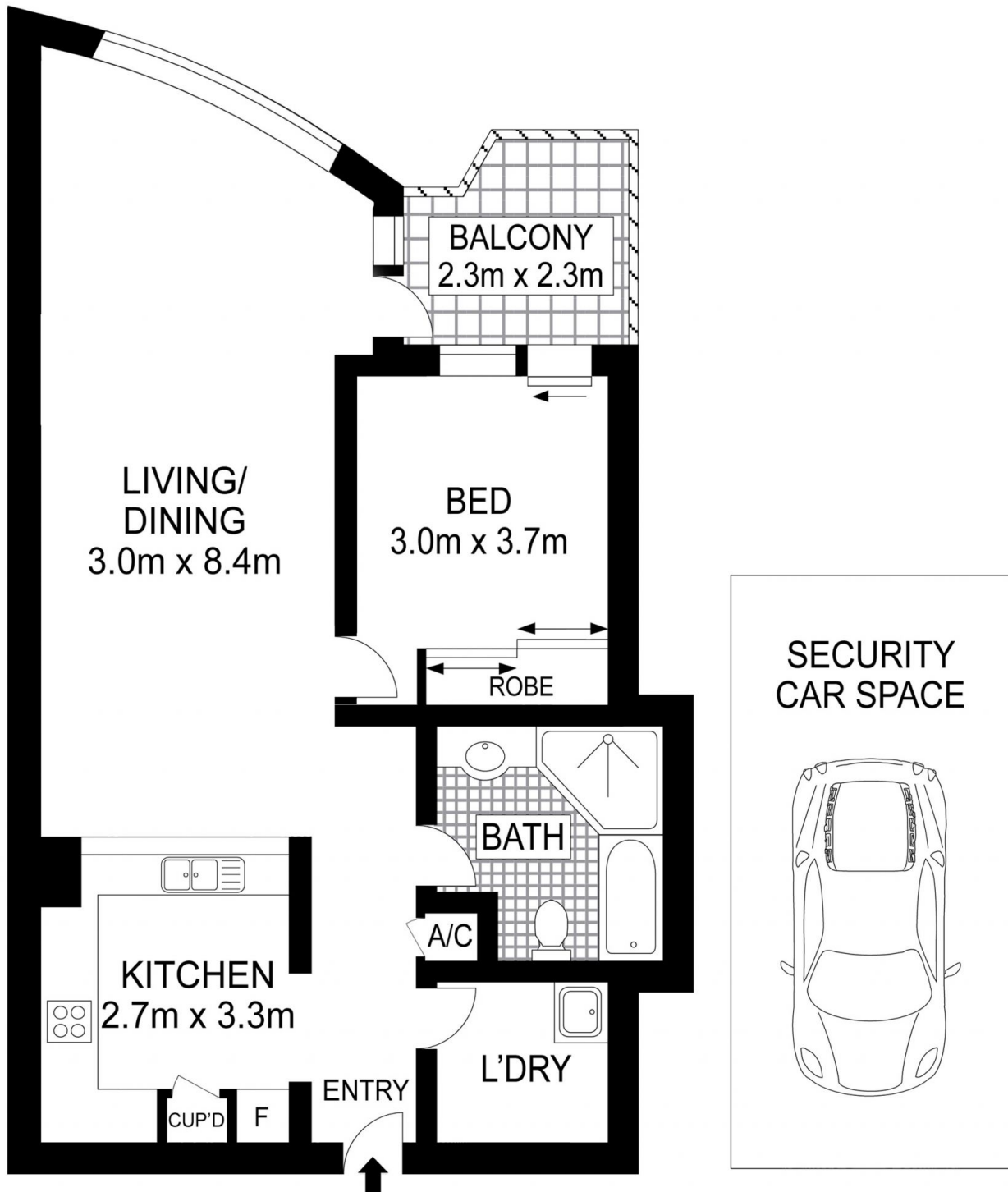

Approx. internal area; 67sq.m
Approx. car space area: 21sq.m
Approx. total area: 88sq.m



Scale in metres. Indicative only. Dimensions are approximate. All information contained herein is gathered from sources we believe to be reliable. However we cannot guarantee its accuracy and interested persons should rely on their own enquiries.

1306/352 Sussex Street, Sydney