



36/267 Castlereagh Street Sydney NSW

2 2 1

Set at the Northern end of the tightly held Museum Tower, and embracing the spectacular views of Hyde Park & Sydney Harbour, is this immaculate 2 bedroom apartment of immense comfort and charm.

Conveniently located opposite the heritage Mark Foy building, and moment to Museum Station and Hyde Park, the apartment is a must have for any connoisseur of good taste for an enjoyable quiet and peaceful CBD living.

East/West cross ventilation design aglow in refreshing morning sun

Much sought after corner position with only one common wall

108sqm of living space with abundance of natural light

2 bedroom, 2 bathroom, large sunroom plus open balcony

Building Size : 108 sqm

View

: <https://www.srmetro.com.au/sale/nsw/sydney-city/sydney/residential/apartment/5716272>



Paul Ding
02 9283 2832

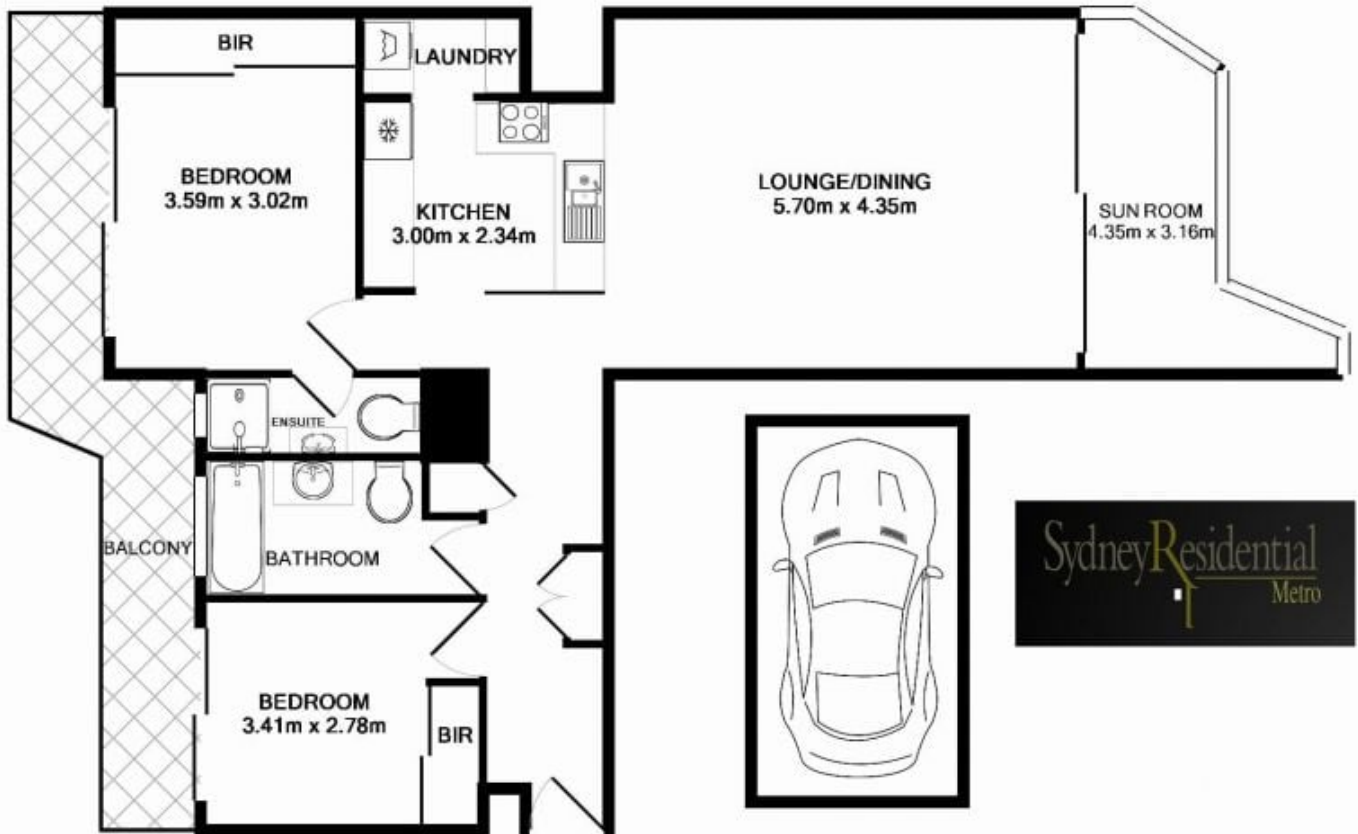

APARTMENT
APPROX. FLOOR
AREA 108.0 SQ.M.

SECURE CAR SPACE
APPROX. FLOOR
AREA 15.0 SQ.M.

TOTAL APPROX. FLOOR AREA 123.0 SQ.M. (1324 SQ.FT.)
Measurements are approximate. Not to Scale. For illustrative purposes only.
Produced by Open2view.com.au