



**312/569 George Street SYDNEY NSW**

1 1 1

Set right in the vibrant heart of the CBD opposite World Square shopping centre, with every conceivable amenity at its doorstep, this well kept one bedroom apartment is perfectly positioned with unmatched convenience.

Open City view with dual North aspect  
 Generous double bedroom with built-in wardrobes  
 Inviting lounge/dining flows to sunny balcony  
 Elegant granite bench top kitchen with stainless steel appliances  
 Security car space on title  
 R/C air-conditioning, internal laundry  
 24/7 security with indoor resort facilities

Strata Levies: \$1226 qtr

**Building Size** : 7 sqm  
**View** : <https://www.srmetro.com.au/sale/nsw/sydney-city/sydney/residential/apartment/5716234>



**Paul Ding**  
 02 9283 2832

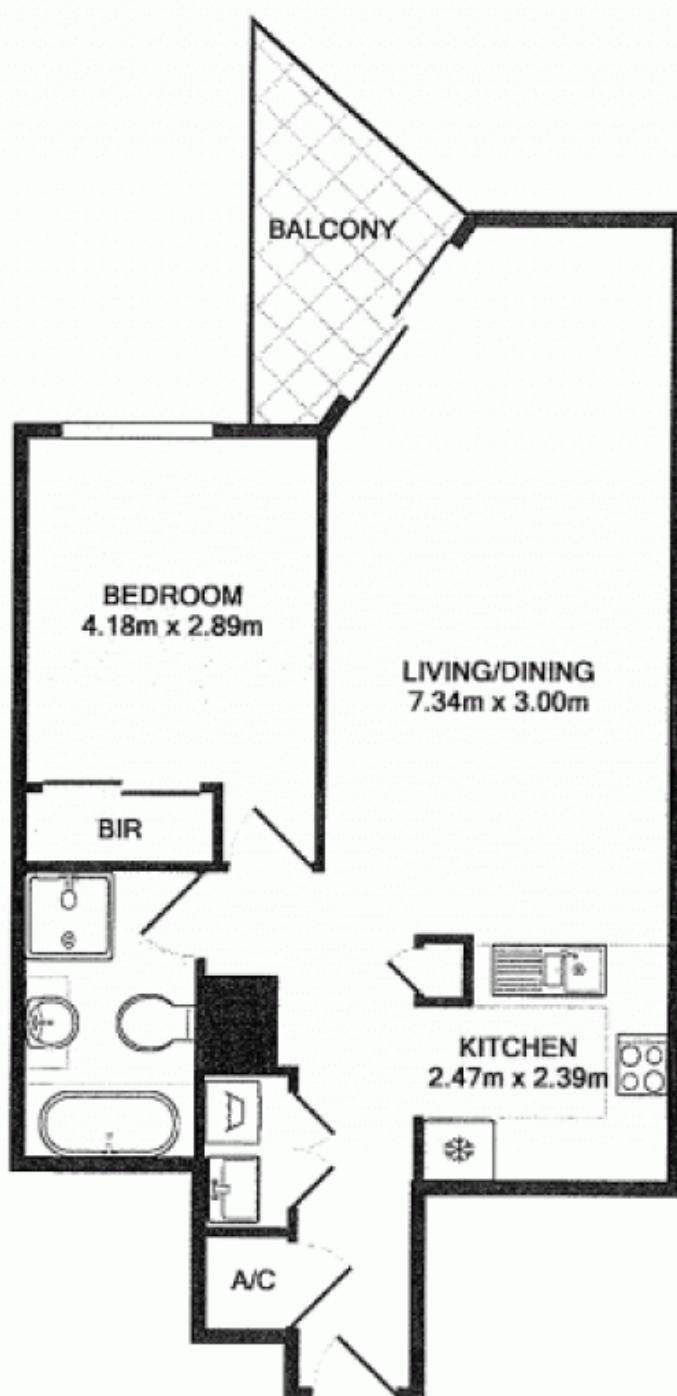

APARTMENT  
APPROX. FLOOR  
AREA 62.0 SQ.M.

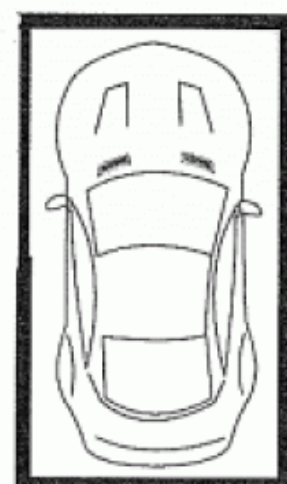

SECURE CAR SPACE  
APPROX. FLOOR  
AREA 20.0 SQ.M.



TOTAL APPROX. FLOOR AREA 82.0 SQ.M.  
Measurements are approximate. Not to Scale. For illustrative purposes only.  
Produced by Open2View.com.au